

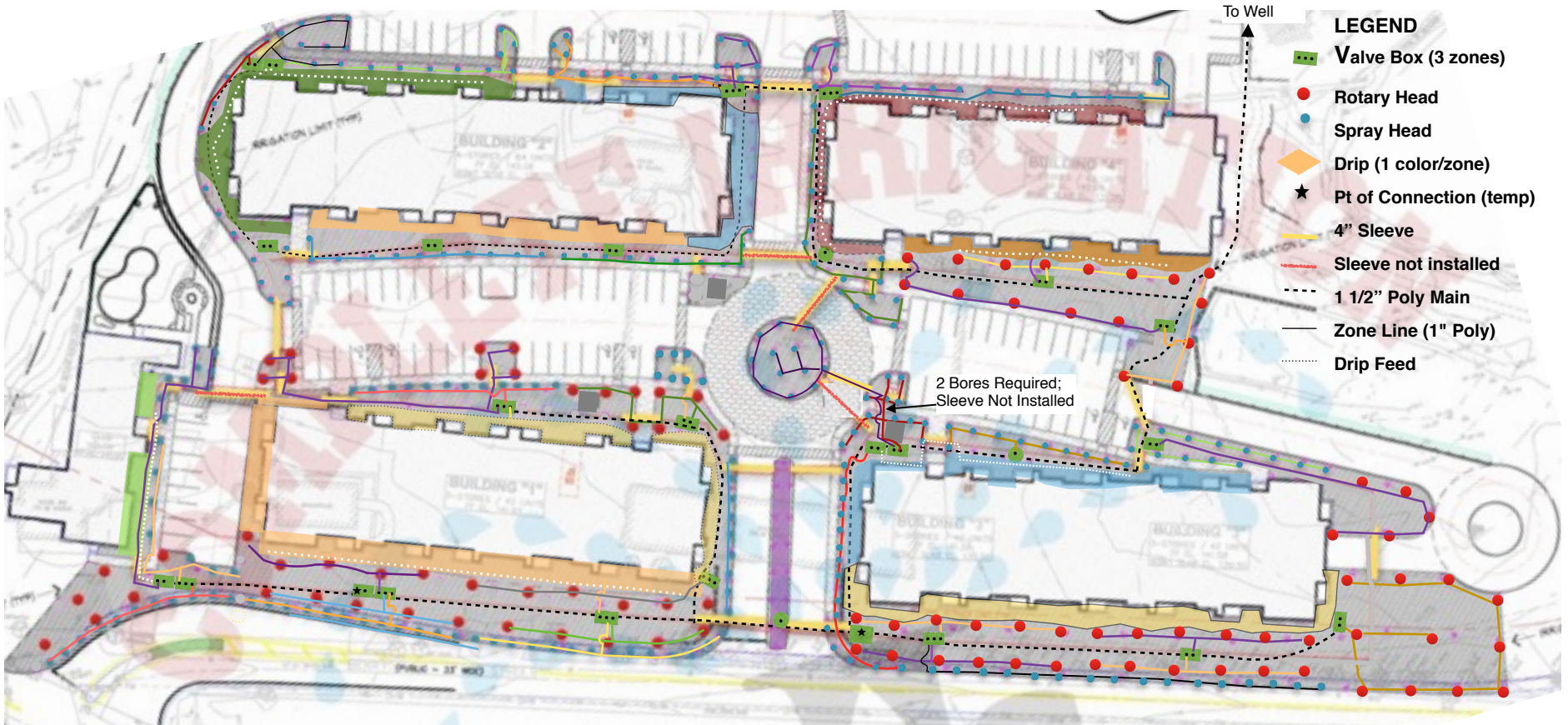

Complete Irrigation Services, Inc.	11/16/2016	For: BERRY FARM
3 Industrial Dr.	Drawn By: Stanley Glick	Berry St
Smithfield, RI 02917	401-232-7400	North Andover, MA

DRAWING
IR-8

**AS-BUILT OF IRRIGATION AT:
BERRY FARMS,
NORTH ANDOVER, MA
As of 11/16/2016**



- LEGEND**
- Valve Box (3 zones)
 - Rotary Head
 - Spray Head
 - ◆ Drip (1 color/zone)
 - ★ Pt of Connection (temp)
 - 4" Sleeve
 - - - Sleeve not installed
 - - - 1 1/2" Poly Main
 - Zone Line (1" Poly)
 - Drip Feed

	Bldg 1	Bldg 2	Bldg 3	Bldg 4	Total
Zones	21	13	15	8	57
Spray Heads	96	75	81	35	287
Rotary Heads	43	0	40	17	100
Drip Irr	3000	2500	1500	1500	8,500 ft